

EQ line of Mirror Cells

Available in sizes from 8 inches to 16 inches

The EQ line of Mirror Cells is designed to provide superior support with a 6-point support system on the back and edge of the mirror. The EQ cells mainly target equatorial mounts as well as large thin mirrors that require more support although it will work for many applications.

- Mirror support locations are determined using the PLOP program
- Spherical bearings allow for self-alignment of 6 point support to mirror
- Mounting brackets are slotted to adjust to your tube or box
- Edge support is customized to mirror specs of thickness & f-ratio
- Edge support adjusts to your mirror diameter
- Fan Kits are available as an option
- 2.1mm x 5mm 12 volt power jack

Materials:

- Black anodized aluminum plates
- Black Delrin and other plastics
- Stainless steel hardware
- 2.1 x 5mm 12V power jack with fan kit

See page two for details on edge support design. For more information on a cell that fits your mirror size, see printable specification sheets.

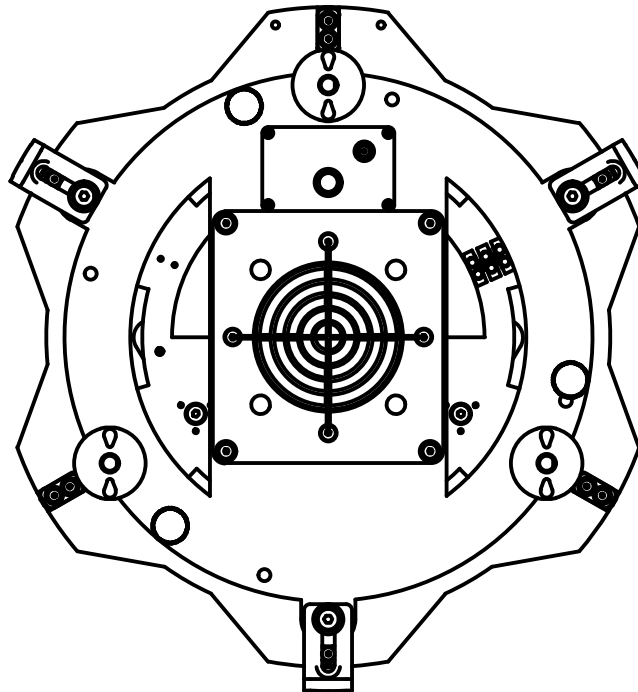

EQ-12.5 Cell shown

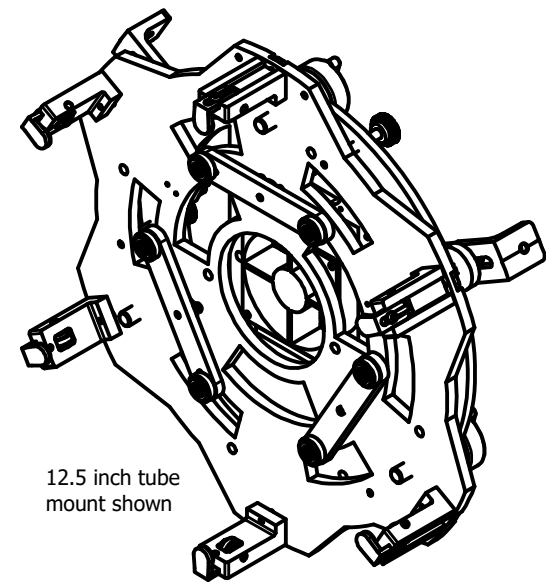

12.5 inch tube
mount shown



www.aurorap.com
6644 SE Jerry Drive
Prineville, Oregon 97754
541-362-5965

EQ line spec sheet, rev1 5-20-20
All dimensions are in inches

EQ line of Mirror Cells

Edge support design- why do we use rollers?

The EQ line of Mirror Cells uses a $\frac{1}{2}$ diameter roller to contact the mirror in 6 places. With variations in temperature the mirror cell will expand and contract at a different rate than the mirror. The rollers will allow for minute movements between them, releasing the mirror from friction and thereby stress. The roller is made of a composite plastic material that is slightly softer than glass but hard enough to resist the development of a flat over time.

The EQ cells mainly target equatorial mounts as well as large thin mirrors that require more support although it will work for many applications.

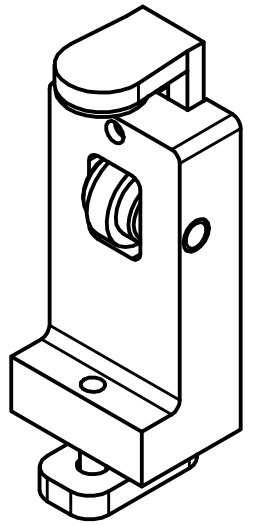

This dimension is determined by your mirror specs.

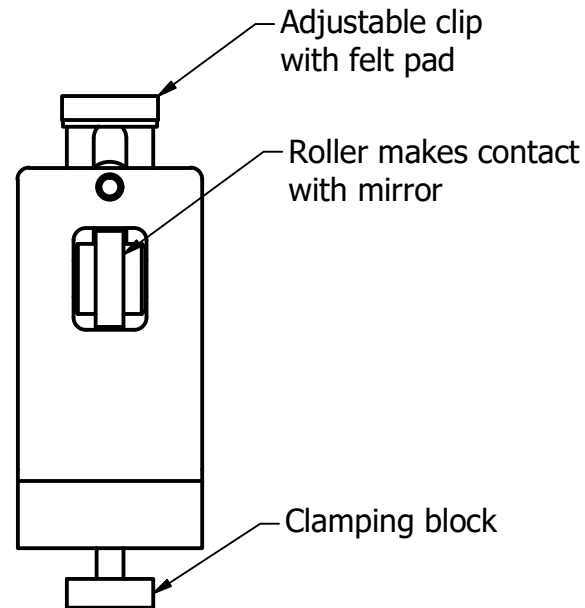
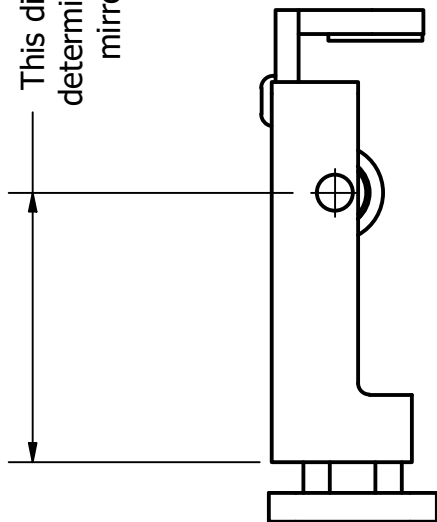

www.aurorap.com
6644 SE Jerry Drive
Prineville, Oregon 97754
541-362-5965

EQ line spec sheet #2, rev1 5-20-20
All dimensions are in inches